

# CHASKA 34, CHASKA 335S, CHASKA 29, CHASKA 25

GAS INSERTS

Chaska 34 Log with a Rectangle Black screen front, with optional Rustic Brick and a custom 3-sided shroud



QUALITY FIREPLACES FOR LIFE.

**KOZY**  **HEAT**  
FIREPLACES

# CHASKA SERIES

## Decorative Safety Screen Fronts

Sizes shown below:

Chaska 34 & 335S / Chaska 29 / Chaska 25



**Rectangle Screen Front**  
with optional Black Enamel panels  
Screen Front available in Black,  
Brushed Stainless



**Rectangle Screen Front**  
In Brushed Nickel Overlay with the Rock Kit  
with Black Glass panels  
Screen Front available in Antique Copper, Brushed Nickel  
(Not available for Chaska 25)



**Prairie Screen Front**  
in Black with optional Rustic Brick refractory  
Screen Front available in Black

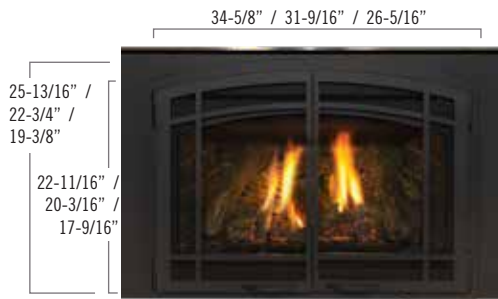

**Arched Prairie Full Door Screen Front**  
with optional Traditional Brick panels  
Screen Front available in Black



**Arched Prairie Screen Front**  
With Rock Kit and Black Glass panels  
Screen Front available in Black



**Arched Screen Front**  
with optional Black Enamel panels  
Screen Front available in Black



**Arched Mission Screen Front**  
in Vintage Bronze with Traditional Brick refractory  
Screen Front available in Vintage Bronze



Chaska 29 Log shown with a Rectangle Screen Front with optional Black Glass panels custom 4-sided shroud, and a low mantel kit

# CHASKA SERIES





## Remote Control Options

### Chaska 34, Chaska 29 & Chaska 25 Control



Komfort Kontrol Remote



-  Thermostat function
-  Flame height modulation
-  Fan speed modulation
-  Light kit modulation
-  IPI to continuous pilot

### Chaska 335S, Chaska 29 MV Millivolt Option Controls



On/Off Remote



Thermostat Remote  
w/ Timer

# CHASKA SERIES

## Media & Refractory Options



Log Set with optional Traditional Brick Refractory



Log Set with optional Rustic Brick Refractory



Crushed Glass with optional Enamel panels\*  
Enamel panels standard in the Chaska 34 & 29 Glass \*Unavailable in the Millivolt, Rock kit, and Chaska 25 versions.



Rock Kit with Black Glass panels\*  
\*Black Glass panels are available in the Chaska Rock, Log and Millivolt Versions



Beach Accent Kit

Model + Media	Refractory Options
Chaska 34, 29, & 25 <b>LOG</b>	Traditional Brick, Rustic Brick, Black Glass
Chaska 34 & 29 <b>ROCK</b>	Black Glass
Chaska 34 & 29 <b>GLASS</b>	Enamel

Model + Media	Refractory Options
Chaska 335S	Traditional Brick, Black Glass & Rustic Brick
Chaska 25	Traditional Brick, Rustic Brick, & Black Glass

## Glass Media

### Crushed Glass



Reflective Midnight



Reflective Copper

### Crystals



Glacier



Amber



Black



Seabreeze



Chaska 29 Glass with a Rectangle Screen Front in Brushed Stainless, Glacier Crystal Glass, optional Beach Accent Kit and a custom 4-sided shroud



Chaska 29 Rock shown with an Arched Mission screen front in Vintage Bronze and Optional Black Glass refractory

## Refractory/Panel Options



Traditional Brick



Rustic Brick



Black Glass Panel



Enamel Panel

## Burn Videos



Chaska 34 Rock



Chaska 34 Crushed Glass  
with a Beach Accent Kit



Chaska 34 Log



Chaska 29 Rock



Chaska 29 Log



Chaska 335S



Chaska 25

# CHASKA SERIES

The Chaska 34 (CSK 34-L, CSK 34-G & CSK 34-R), Chaska 29 (CSK 29-L, CSK 29-G & CSK 29-R) and Chaska 25 come standard with an Electronic Ignition Pilot System. The included Komfort Kontrol remote will adjust the flame and fan speed. The Chaska 335S model comes standard with a millivolt operating system and fan kit. The Chaska 29 model offers an optional millivolt operating system and fan kit.

## Specifications

Model	Chaska 34 IPI	Chaska 335S	Chaska 29 Log & Rock	Chaska 29 Glass	Chaska 29 MV	Chaska 25
Height	23"	23"	19-1/4"	19-1/4"	19-1/4"	17-1/2"
Width	33-3/8"	33-3/8"	29"	29"	29"	25-3/8"
Back Width	24-3/8"	24-3/8"	18-7/8"	18-7/8"	18-7/8"	20-3/8"
Depth	16"	16"	14-1/2"	14-1/2"	14-1/2"	15"
Weight	150 lbs.	150 lbs.	29-L-120 lbs 29-R-121 lbs	140 lbs	140 lbs	107 lbs
Viewing Area	30-1/8" X 17-13/16"	29-5/8" X 15-13/16"	26-1/8" X 12-7/8"	26-1/8" X 12-7/8"	26-1/8" X 12-7/8"	22-1/8" X 12-5/16"
BTU NG High / Low	34,000 / 18,500	36,000 / 22,000	30,500 / 16,000	25,500 / 14,000	28,500 / 18,500	26,000 / 13,500
BTU LP High / Low	34,000 / 18,500	36,500 / 22,000	30,000 / 16,000	25,500 / 13,500	29,000 / 22,000	25,500 / 13,000
ENERGUIDE P.4 NG / LP	73.22% / 76.49%	65.74% / 66.63%	72.27% / 72.36%	60.8% / 63.21%	71.26% / 71.33%	71.44% / 72.08%
Steady State NG / LP	77% / 79%	80% / 75%	74% / 74%	72.21% / 72.26%	74% / 74%	77.58% / 78.17%
AFUE % NG / LP	75% / 77%	73.8% / 76.2%	71% / 72.12%	66.62% / 66.09%	71% / 72.12%	69.79% / 70.33%
Valve System	IPI - Standard on all Verisons	Millivolt	IPI - Standard on all Verisons	IPI - Standard on all Verisons	Millivolt	IPI
Ember Light Kit	Standard (CSK 34-L, CSK 34-R)	N/A	Standard	N/A	N/A	N/A
Accent Light Kit	Standard (CSK 34-G)	N/A	N/A	Standard	N/A	N/A
Glass Media	Required (CSK 34-G)	N/A	N/A	Required	N/A	N/A
Ceramic Glass	Standard	Standard	Standard	Standard	Standard	Standard
Fan Kit Availability	Standard for All Versions	Standard	Standard for All Versions	Standard	Standard	Standard
Screen Front	Required	Required	Required	Required	Required	Required

Features, Options & Specifications are subject to change.

## Clearances

Model	Chaska 34	Chaska 335S	Chaska 29 Log & Rock	Chaska 29 Glass	Chaska 29 MV	Chaska 25
From insert to combustible floor in front	Refer to chart in manual	Refer to chart in manual	Refer to chart in manual	Refer to chart in manual	Refer to chart in manual	Refer to chart in manual
From insert to side wall	6"	12"	6"	6"	6"	3"
Mantel 9" deep from top of insert*	16"	16"	16"	16"	16"	9"
Mantel 9" deep from top of insert with Low Mantel Kit*	11"	11"	11"	11"	11"	N/A

\*Low Mantel Kit can attach to any Rectangle Screen Front or (square) Prairie Screen Front to reduce mantel clearances by up to 5"

Refer to the installation manuals for complete installation & venting requirements. See additional mantel clearance configurations in the installation manual.

Note: Over time, antique copper will react with oxygen, heat, and other aspects of the environment and naturally change color, or patina.

Each unit factory tested

Certified to ANSI Z21.88 Vented Gas Heaters

## Venting

A gas insert will help in eliminating the heat loss and cold down drafts that you have likely experienced from your existing fireplace and chimney. As the first company to introduce direct-vent technology to gas inserts, Kozy Heat inserts and fireplaces use 100% outside air for combustion. Our inserts and dual 3" aluminum flex venting structure create a sealed system and eliminates the potential of bringing smoke or fumes into the home. When compared to gas logs or "ventless" inserts, this is the safest and most efficient choice that you can make for your family.

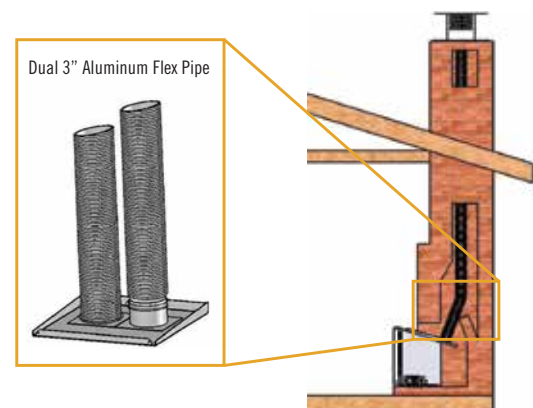

### Chaska 34

LEFT SIDE

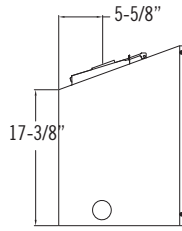

FRONT

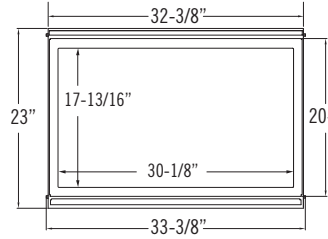

RIGHT SIDE

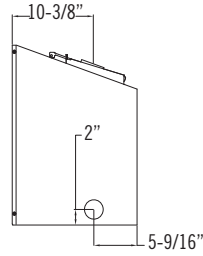

TOP

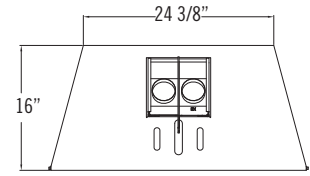

### Chaska 335S

LEFT SIDE

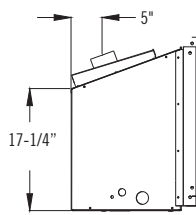

FRONT

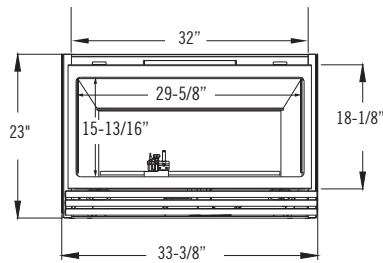

RIGHT SIDE

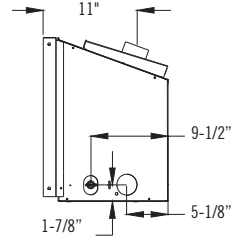

TOP

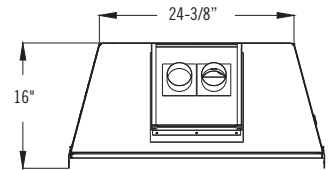

### Chaska 29

LEFT SIDE

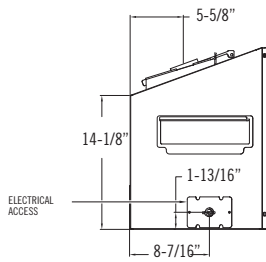

FRONT

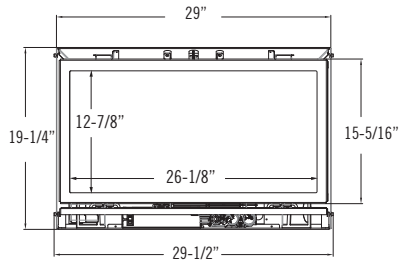

RIGHT SIDE

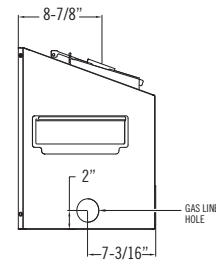

TOP

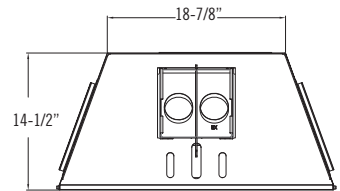

### Chaska 25

LEFT SIDE

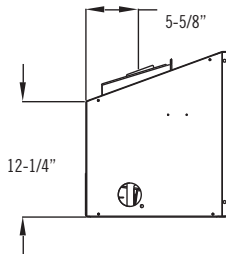

FRONT

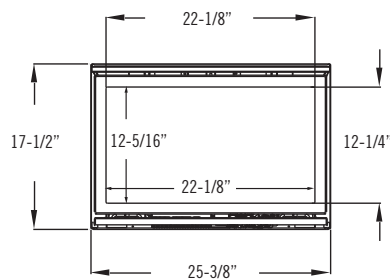

RIGHT SIDE

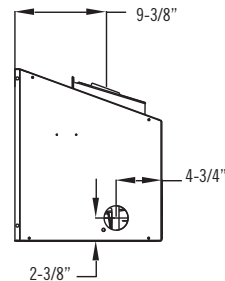

TOP

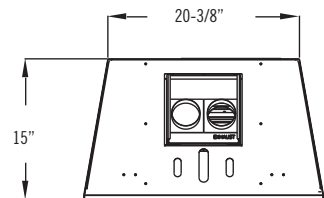



Chaska 335S shown with an Arched Prairie Full Door Screen Front and a Traditional Brick refractory

Fireplace brochures are for advertising purposes only. Refer to the specific fireplace manual for installation.

# CHASKA SERIES

## Existing Fireplace Requirements

### Chaska 34 & 335S

**Existing Fireplace Opening must be at least:**

- Height: 23-1/2"
- Width: 33-1/2"
- Back Width: 24-1/2"
- Depth: 16-3/8" (CSK-34)
- Depth: 16-1/2" (CSK-335S)

**Existing Chimney:**

Inside Diameter:

- Factory built solid fuel chimney: 7" min.
- Masonry chimney: 6" x 8" min.
- Minimum chimney height: 12'
- Maximum chimney height: 50'

### Chaska 29

**Existing Fireplace Opening must be at least:**

- Height: 19-1/4"
- Width: 29-1/2"
- Back Width: 18-7/8"
- Depth: 15"

**Existing Chimney:**

Inside Diameter:

- Factory built solid fuel chimney: 7" min.
- Masonry chimney: 6" x 8" min.
- Minimum chimney height: 10'
- Maximum chimney height: 50'

### Chaska 25

**Existing Fireplace Opening must be at least:**

- Height: 17-5/8"
- Front Width: 25-7/8"
- Back Width: 20-5/8"
- Depth: 15-1/4"

**Existing Chimney:**

Inside Diameter:

- Class 'A' metal: 7" I.D.
- Masonry Chimney: 6" x 8" I.D.
- Minimum chimney height: 10'
- Maximum chimney height: 35'

**Vertical Termination ONLY**

(Chaska 34, Chaska 335s & Chaska 29)

- Minimum vent run: 10'
- Maximum vent run: 50'

**Vertical Termination ONLY (Chaska 25)**

- Minimum vent run: 10'
- Maximum vent run 35'

**Vent System Approval & Requirements**

These models are approved for use with the following Vent Systems rigid and flexible pipe:–

- Kozy Heat™ - #816 venting
- Simpson Dura-Vent™
- Selkirk Metalbestos™
- Ameri-Vent™
- ICC™

## Shroud Dimensions

\*Shroud is Required for Installation

### Chaska 34 & 335S

- 27" x 40"
- 30" x 44"
- 33" x 46"

\*Custom sizes available where applicable

### Chaska 29

- 25" x 38"
- 27-1/2" x 42"
- 30" x 44"

\*Custom sizes available where applicable

### Chaska 25

- 22-1/2" x 36"
- 25" x 38"
- 30" x 44"

\*Custom sizes available where applicable

In order to continually provide the highest quality product available, features/options, specifications, & dimensions are subject to change. Flame appearance and characteristics may be affected by altitude, fuel type, venting configuration, and other factors. Refer to the unit installation manual for complete installation instructions. Installation must conform with local building codes. **In some regions it may be possible that this appliance qualifies for an energy rebate. See your local dealer for details regarding promotions and qualifications.**

Manufactured by Husson Mfg. Co., Inc.  
204 Industrial Park Road, Lakefield, MN 56150  
Phone 1-800-253-4904 www.kozyheat.com

4-22



Product Line:



For complete information on the Kozy Heat product line, please contact us at:

FOR CALIFORNIA RESIDENTS ONLY

⚠ California Proposition 65 Warning

**WARNING:** This product can expose you to chemicals including Carbon Monoxide, that is an externally vented by-product of fuel combustion, which is (are) known to the State of California to cause birth defects or other reproductive harm. For more information, visit www.P65Warnings.ca.gov.